

**THE COUNCIL OF THE BOROUGH OF MILTON KEYNES
(THE COUNCIL OF THE BOROUGH OF MILTON KEYNES
(VARIOUS ROADS, WOBURN SANDS) (CONSOLIDATION OF
PARKING AND WAITING RESTRICTIONS) ORDER 2002)
VARIATION ORDER 2011**

The Council of the Borough of Milton Keynes ("the Council") in exercise of its powers under sections 1(1), 2(1) and (2) and 4(2) of the Road Traffic Regulation Act 1984 ("the Act"), Part IV of Schedule 9 to the Act and of all other enabling powers, and after consultation with the chief officer of police in accordance with Part III of Schedule 9 to the Act, hereby makes the following Order:

PART 1

IMPLEMENTATION, CITATION AND DEFINITIONS

1. This Order shall come into operation on 18 March 2011 and may be cited as "The Council of the Borough of Milton Keynes (The Council of the Borough of Milton Keynes) (Various Roads, Woburn Sands) (Consolidation of Parking and Waiting Restrictions) Order 2002) Order 2011".
2. Any reference in this Order to any enactment shall be construed as a reference to that enactment as amended by any subsequent enactment.
3. The plans annexed to this Order identify the areas subject to this Order, provided that where there is any inconsistency between the plans and the Schedules it is the wording of the Schedules which shall prevail.

PART 2

VARIATIONS

4. The Council of the Borough of Milton Keynes (Woburn Sands) (Consolidation of Parking and Waiting Restrictions) Order 2002 ("The Principal Order") is varied as provided by the following provisions of this order:-
5. The following definition is inserted into PART 1 of The Principal Order:

"Carer" means a person who provides care to those in need of medical, nursing or personal assistance and employed either by a public service body or an officially registered company.
6. PART 4 of The Principal Order is amended to the extent stated below:
7. Article 21 in The Principal Order is revoked and replaced with the following:

Each area on a highway which is described as a designated parking place in Schedule 4 to this Order is designated as a parking place for:-

 - (a) Residents;

- (b) Residents' visitors;
- (c) Carers.

8. The following heading is inserted into PART 4 of The Principal Order:

CARER PERMITS

9. The following Articles are inserted into PART 4 of The Principal Order:

- 41.(a). (1) Any public service body or an officially registered company employing carers who are required to make house calls as a part of their normal duty may apply to the Council for the issue of carer permits to be held or used by carers for the purpose of making visits to properties within the areas defined in Schedule 4;
- (2) Any such application shall be made on a form issued by the Council and shall include the information required by such form and shall be accompanied by a remittance for such charge as is specified in Schedule 6;
- (3) Any person employed as a carer by a public service body or an officially registered company who is the user of passenger vehicle, dual purpose vehicle, goods vehicle, moped or motor cycle may validly obtain from the said public service body or officially registered company a carer permit for the leaving of the said vehicle in a parking place specified in Schedule 4 during the prescribed hours whilst making a house call as a part of their normal duty.
- (4) On receipt of an application made under the foregoing provisions of this article by a public service body or officially registered company the Council upon being satisfied that the application meets the requirements of this article, shall issue to that applicant sufficient carer permits, provided that, subject to the provisions of Article 41.(a) of this Order, any such permit would not be valid for any period during which any other carer permit issued to an individual vehicle would be valid.
- (5) The Council may at any time require an applicant for a carer permit to produce to an officer of the Council such evidence in respect of an application for a carer permit made to them as they may reasonably require to verify any information given to them.
- 41.(b). (1) The applicant for a carer permit, may surrender a carer permit to the Council at any time and shall surrender a carer permit to the Council on the occurrence of any of the events in respect of a carer permit, as are set out in paragraphs (3) or (5) of this article.
- (2) The Council may, by notice in writing served on the applicant for a carer permit, by sending the same by the recorded delivery service to the address shown by that applicant on the application for the carer permits or at any other address believed to be that applicant's place of business or registered office, withdraw a carer permit if it appears to the Council that any one of the events in respect of a carer permit as set out in paragraph (3) of this article has occurred and the applicant for the carer

permits shall surrender the carer permit to the Council within 48 hours of the service of such notice.

- (3) The events referred to in the foregoing provisions of this article are:
- (a) the holder of a carer permit ceasing to be an eligible employee of a public service body or officially registered company by which they were employed at the time the application was made;
 - (b) the holder of a carer permit ceasing to be required to make house calls to properties within the areas defined in Schedule 4 as a part of their normal duty;
 - (c) the holder of a carer permit ceasing to be the user of the vehicle in respect of which the carers permit was issued;
 - (d) the vehicle in respect of which a carer permit was issued being adapted or used in such a manner that it is not a vehicle of the class specified in Article 41.(a) (3) of this Order;
 - (e) the issue of a replacement carer permit by the Council under the provisions of Article 41.(c) of this Order;
 - (f) the permit having been obtained by fraudulent means.
- (4) A carer permit shall cease to be valid at the end of the permit period specified thereon or on the occurrence of any one of the events set out in paragraph (3) of this Article, whichever is the earlier;
- (5) Where a carer permit is issued to any applicant upon receipt of a cheque and the cheque is subsequently dishonoured, the permit shall cease to be valid and the Council shall by notice in writing served on the applicant to whom such a permit was issued by sending the same by the recorded delivery service to the applicant for the carer permit at the address shown by that applicant on the application for the permit or at any other address believed to be that applicant's place of business or registered office, require the surrender of the permit to the Council within 48 hours of the service of the aforementioned notice;
- (6) The Council may at any time require the applicant for, holder or user of a carer permit to produce to an officer of the Council such evidence in respect of any permit issued by them as they may reasonably require.
- 41.(c) (1) If a carer permit is mutilated or defaced or the figures or particulars on it have become illegible or the colour of the permit has become altered by fading or otherwise, the applicant for the carer permit shall surrender it to the Council and may apply to the Council for the issue to them of a replacement permit and the Council, upon the receipt of the carer permit if such receipt is accompanied by an application for a replacement carer permit and by a remittance for such charge as is specified in Schedule 6, shall issue a replacement permit so marked;

- (2) If a carer permit is lost or destroyed, the applicant for the permit may apply to the Council for the issue to him of a replacement carer permit and the Council, upon being satisfied as to such loss or destruction, and upon receipt by the Council of an application for a replacement carer permit accompanied by a remittance for such charge as is specified in Schedule 6, shall issue a replacement permit so marked;
- (3) The provisions of this Order shall apply to a replacement carer permit and an application for a replacement carer permit as if it were a carer permit or, as the case may be, an application therefor.
- 41.(d) A carer permit shall be in writing and shall include the following particulars:
- (1) The registration mark of the vehicle in respect of which the permit has been issued;
- (2) The month of expiry being the last day of the permit period;
- (3) An authentication that the carer permit has been issued by the Council.
- 41.(e) A carer permit shall only be valid for the duration of the permit period in respect of the year for which it is issued.
- 41.(f) (1) The applicant for a carer permit who surrenders a carer permit to the Council before the permit becomes valid shall be entitled to a refund of the charge paid in respect of the issue thereof;
- (2) The applicant for a carer permit who surrenders a carers permit to the Council after the permit has become valid shall be entitled to a refund of the charge paid in respect of each full calendar month remaining unused before the end of the permit period calculated from the time of receipt by the Council of the surrendered permit.

10. The following heading is inserted into The Principal Order:

"SCHEDULE 6"

11. The following item is inserted into Schedule 6 of The Principal Order:

CARER PERMIT CHARGES

	<u>PERMIT TYPE</u>	<u>PERIOD</u>	<u>CHARGE</u>	<u>CODE</u>
1	Carer Permit	Annual	FREE	M

12. Item NW3 in Schedule 1 of The Principal Order is revoked and replaced with the following:

JUNCTION OF CHAPEL STREET AND HIGH STREET
SOUTH-WEST SIDE

NW3 From a point on Chapel Street approximately 20 metres south-west of its junction with High Street continuing onto High Street for a distance of approximately 29 metres in a north-easterly then southerly direction.

13. The following items in Schedule 1 of The Principal Order are revoked and replaced with:

DOWNHAM ROAD
SOUTH-WEST AND SOUTH-EAST SIDE

NW10 From a point in line with the north-western kerbline of Aspley Hill, continuing for a distance of approximately 75 metres in a north-westerly and a south-westerly direction.

JUNCTION OF HARDWICK ROAD AND HIGH STREET
NORTH-WEST SIDE

NW12 From a point on Hardwick Road approximately 60.5 metres west of its junction with High Street continuing onto High Street for a distance of approximately 92 metres in an easterly then northerly direction.

JUNCTION OF HIGH STREET AND THE ACCESS ROAD
LEADING TO SHELTON COURT
SOUTH-WEST SIDE

NW22 From a point approximately 50.5 metres south of its junction with the access road leading to Shelton Court continuing into Shelton Court for a distance of approximately 95 metres in a northerly then westerly direction.

14. Item NW28 in Schedule 1 of The Principal Order is revoked and replaced with the following:

STATION ROAD
SOUTH-WEST SIDE

NW28 From a point on Spring Grove approximately 10.5 metres south-west of its junction with Station Road continuing onto Station Road then into Cranbrook for a distance of approximately 110 metres in a north-easterly then north-westerly direction.

15. Item NW30 in Schedule 1 of The Principal Order is revoked and replaced with the following:

CHAPEL STREET, HIGH STREET, STATION ROAD AND THEYDON AVENUE
SOUTH-WEST SIDE

NW30 From a point on Chapel Street approximately 20 metres south-west of its junction with High Street continuing onto High Street then Station Road then Theydon Avenue for a distance of approximately 289.5 metres.

16. Item NW31 in Schedule 1 of The Principal Order is revoked and replaced with the following:

STATION ROAD
SOUTH-WEST SIDE

NW31 From a point in line with the eastern boundary line of numbers 84 and 86 Station Road continuing for a distance of approximately 23.5 metres in a south-easterly direction.

17. Item NW34 in Schedule 1 of The Principal Order is revoked and replaced with the following:

STATION ROAD
NORTH-WEST SIDE

NW34 From a point on Theydon Avenue approximately 25.5 metres south-west of its junction with Station Road continuing onto Station Road then into Spring Grove for a distance of approximately 166 metres in a north-easterly then north-westerly direction.

18. The following items are inserted into Schedule 1 of The Principal Order:

JUNCTION OF HIGH STREET AND THE ACCESS ROAD LEADING TO SHELTON COURT
SOUTH-WEST SIDE

NW50 From a point approximately 33.5 metres north of its junction with the access to Shelton Court continuing into Shelton Court for a distance of approximately 68.5 metres in a southerly then westerly direction.

JUNCTION OF WOOD STREET AND ASPLANDS CLOSE
NORTH-EAST SIDE

NW51 From a point on Asplands Close approximately 10 metres east of its junction with Wood Street continuing onto Wood Street for a distance of approximately 21.5 metres in a westerly then northerly direction.

SOUTH-EAST SIDE

NW52 From a point on Asplands Close approximately 10 metres east of its junction with Wood Street continuing onto Wood Street for a distance of approximately 15 metres in a westerly then southerly direction.

STATION ROAD
SOUTH-WEST SIDE

NW53 From a point approximately 55 metres north-west of its junction with Cranbrook continuing for a distance of approximately 51.5 metres in a north-westerly direction.

THEYDON AVENUE
WEST SIDE

NW54 From a point in line with the eastern boundary line of number 67 and 69 Theydon Avenue continuing for a distance of approximately 27.5 metres in a north-westerly direction.



Notes:



No Waiting at Any Time

NW51

TRO reference number

Map referred to in the Council of the Borough of Milton Keynes
(The Council of the Borough of Milton Keynes)
(Various Roads, Woburn Sands) (Consolidation of Parking and
Waiting Restrictions) Order 2002) Variation Order 2011

Not to scale

The common seal of the Council of the Borough of Milton Keynes
was hereunto affixed in the presence of:

ASSISTANT DIRECTOR - LAW AND GOVERNANCE

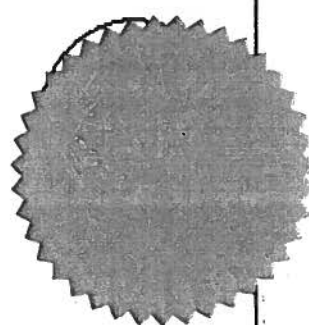

19441

Map 1



Notes:

 No waiting at any time

 Waiting limited to 1 hour
Mon-Sat, 8am-6pm
No return within 2 hours

NW3 TRO reference number

LW2 TRO reference number

Map referred to in the Council of the Borough of Milton Keynes
(The Council of the Borough of Milton Keynes)
(Various Roads, Woburn Sands) (Consolidation of Parking and
Waiting Restrictions) Order 2002) Variation Order 2011

Not to scale

The common seal of the Council of the Borough of Milton Keynes
was hereunto affixed in the presence of:

ASSISTANT DIRECTOR - LAW AND GOVERNANCE

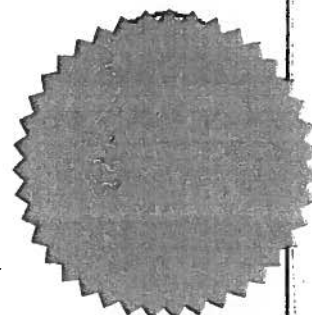

19441

Map 2



Notes:

 No waiting at any time

NW30 TRO reference number

Map referred to in the Council of the Borough of Milton Keynes
(The Council of the Borough of Milton Keynes)
(Various Roads, Woburn Sands) (Consolidation of Parking and
Waiting Restrictions) Order 2002) Variation Order 2011

Not to scale

The common seal of the Council of the Borough of Milton Keynes
was hereunto affixed in the presence of:



ASSISTANT DIRECTOR - LAW AND GOVERNANCE

19441

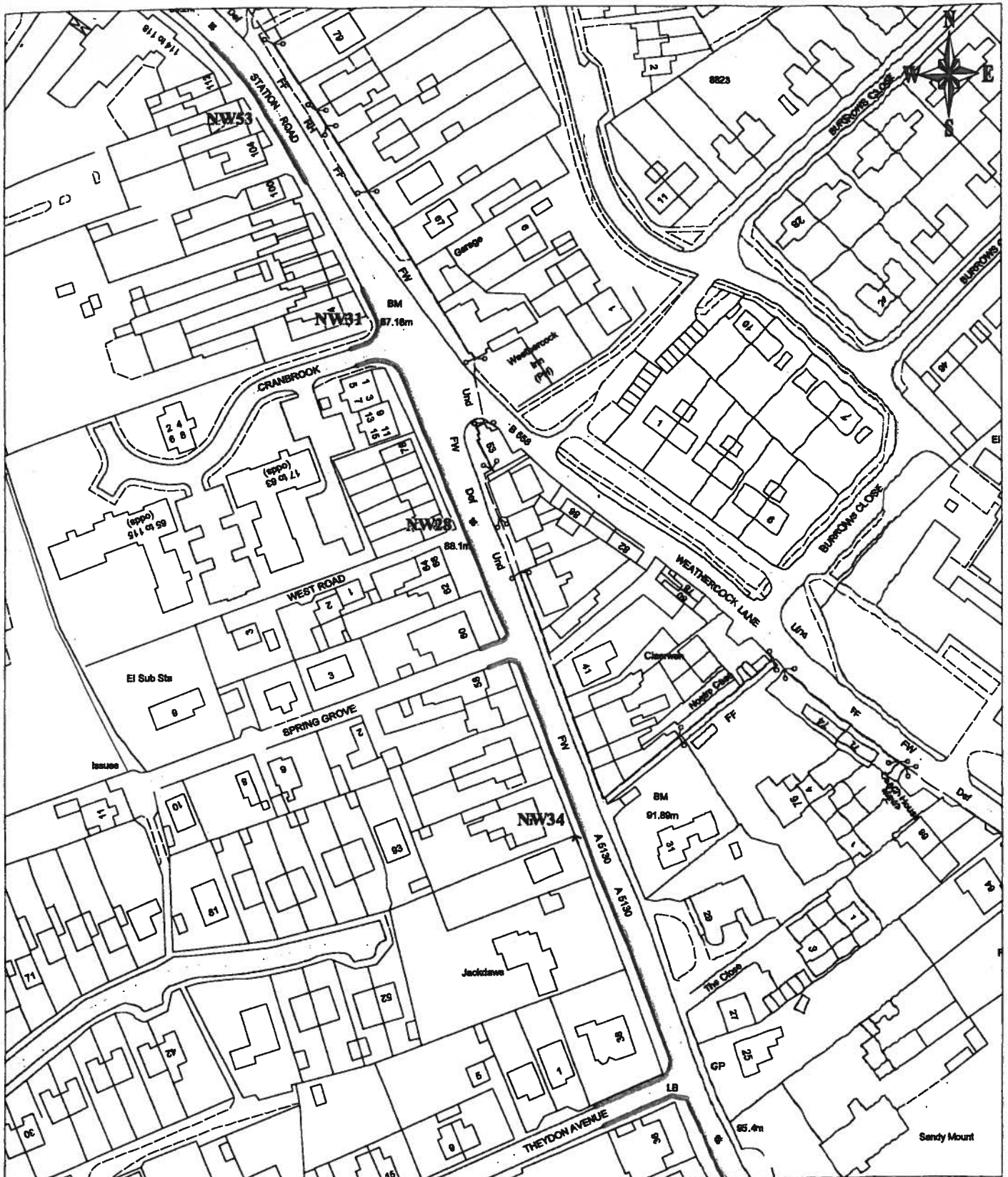
Map 3



Notes:

 No waiting at any time
 NW28 TRO reference number

Map referred to in the Council of the Borough of Milton Keynes
 (The Council of the Borough of Milton Keynes)
 (Various Roads, Woburn Sands) (Consolidation of Parking and
 Waiting Restrictions) Order 2002) Variation Order 2011

Not to scale

The common seal of the Council of the Borough of Milton Keynes
 was hereunto affixed in the presence of:

 ASSISTANT DIRECTOR - LAW AND GOVERNANCE

19441

Map 4



Notes:

 No waiting at any time

NW10 TRO reference number

Map referred to in the Council of the Borough of Milton Keynes
(The Council of the Borough of Milton Keynes)
(Various Roads, Woburn Sands) (Consolidation of Parking and
Waiting Restrictions) Order 2002) Variation Order 2011

Not to scale

The common seal of the Council of the Borough of Milton Keynes
was hereunto affixed in the presence of:

ASSISTANT DIRECTOR - LAW AND GOVERNANCE

19441

Map 5



Notes:

 No waiting at any time

NW10 TRO reference number

Map referred to in the Council of the Borough of Milton Keynes
(The Council of the Borough of Milton Keynes)
(Various Roads, Woburn Sands) (Consolidation of Parking and
Waiting Restrictions) Order 2002) Variation Order 2011

Not to scale

The common seal of the Council of the Borough of Milton Keynes
was hereunto affixed in the presence of:

ASSISTANT DIRECTOR – LAW AND GOVERNANCE

1944

Map 6

19. Item LW2 in Schedule 2 of The Principal Order is revoked and replaced with the following:

HIGH STREET
EAST SIDE

LW2 From a point approximately 11 metres south of its junction with Russell Street continuing for a distance of approximately 69.5 metres in a southerly direction.

20. Item LW3 in Schedule 2 of The Principal Order is revoked and replaced with the following:

HIGH STREET
EAST SIDE

LW3 From a point approximately 98.5 metres south of its junction with Russell Street continuing for a distance of approximately 30 metres in a southerly direction.

THE COMMON SEAL of the **COUNCIL OF THE
BOROUGH OF MILTON KEYNES** was hereunto

affixed this 17th day of March 2011
in the presence of:

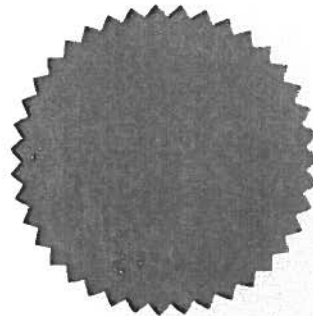

.....
ASSISTANT DIRECTOR – LAW AND GOVERNANCE

19441

Certified to be a true copy of the original

B. B. B. B.

David S. S.
Legal A. A.

Milton Keynes Council

Civic Offices

1 Saxon Gate East

Milton Keynes

MK9 3HG